

Coverlam Top® surface requirements

COVERLAM TOP® REQUIREMENTS

- Recommended for 12 mm- and 20 mm-thick slabs.
- All Coverlam Top® models can be used except polished models.
- It is not necessary to remove the fibreglass mesh from the slab where the induction system is to be installed.

Surface marking

It is advisable to mark the surface of the countertop to indicate where the centre of each burner will be, in order to facilitate the placement of the cookware.

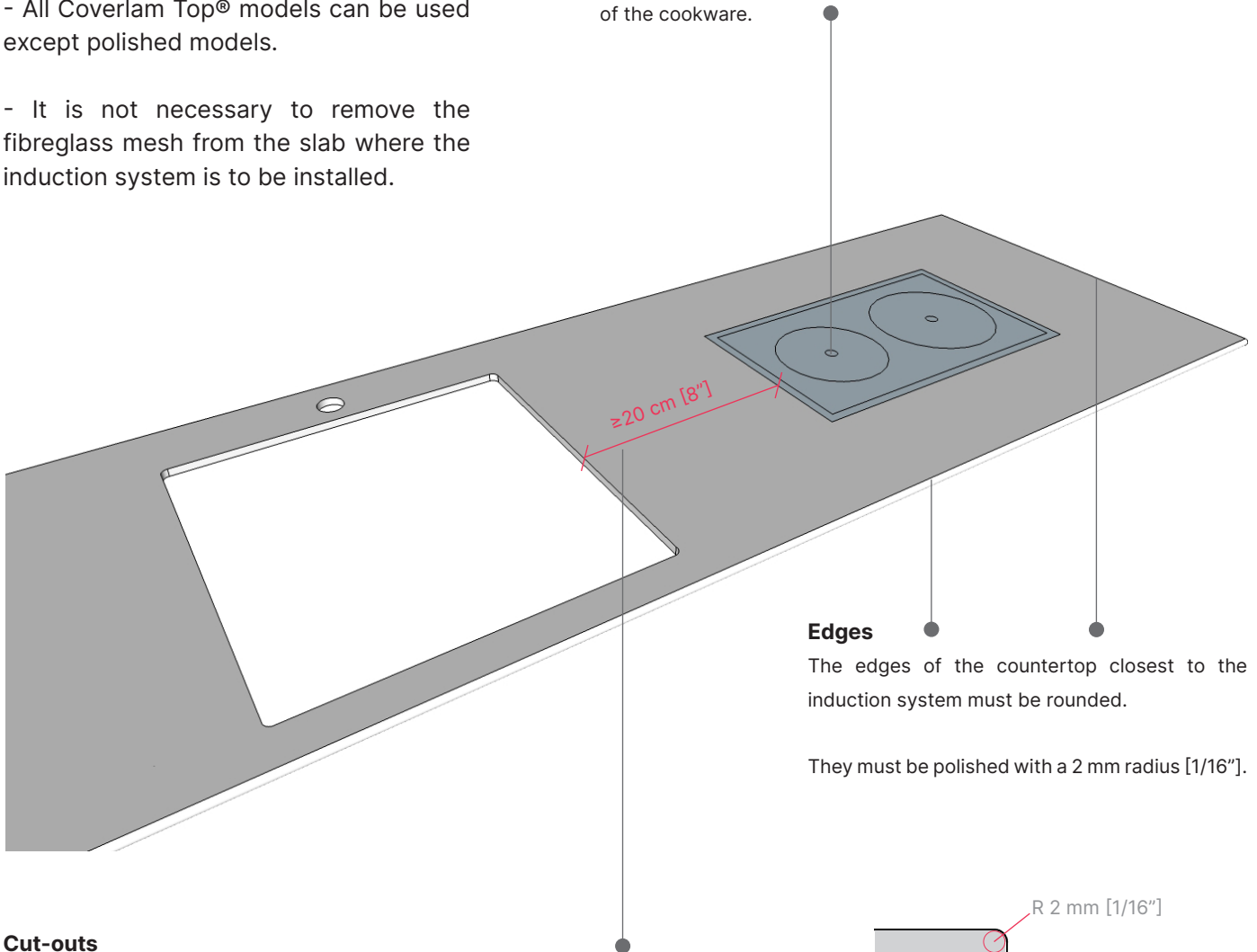

Cut-outs

Leave a distance of at least 20 cm [8"] between the frame of the induction system and any cut-outs in the countertop, to avoid stresses in the slab.

Edges

The edges of the countertop closest to the induction system must be rounded.

They must be polished with a 2 mm radius [1/16"].

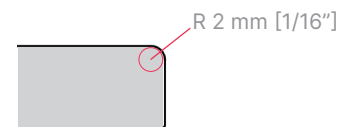

- Consulte la *Guía Técnica de Coverlam Top®* para obtener información adicional sobre corte, diseño, manipulación e instalación como encimeras de cocina.



- Check the *Coverlam Top® Technical Guide* for additional information on cutting, design, handling and installation as kitchen countertops.

INVISIBLE INDUCTION COOKTOP DESIGN AND INSTALLATION GUIDE

APPROVED PRODUCT CARD

rev.01 07/2024

Basic concepts of invisible induction systems

For INDOOR use only

Invisible induction systems are designed to be installed in indoor kitchens. They should never be installed in outdoor countertops.



Cookware

- Cookware must be suitable for induction cooking systems.
- Never heat cookware when empty, as it can reach very high temperatures and damage both the Coverlam Top slab and the induction system.

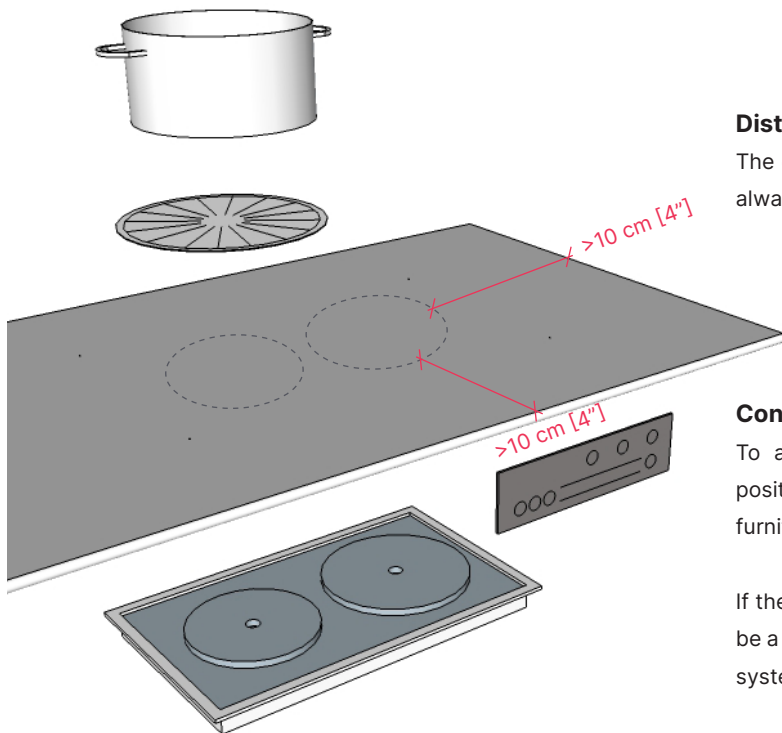

Induction system

Leave a space of at least 2 cm around the induction system for ventilation.

Always leave access to the induction system in case it needs to be repaired or replaced.

Silicone protective cover

- A silicone protective cover **MUST BE USED** during cooking, and it must be provided by the manufacturer of the induction system.
- Prevents cookware from slipping during cooking.
- Prevents unnecessary heating of the countertop, as it diverts the heat reflected by the kitchenware away from the field of induction.

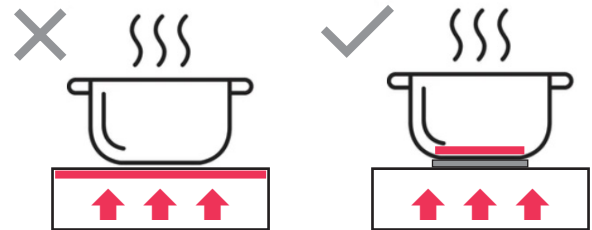

Distance from the edges

The distance from the heat source to the ends of the slab should always be at least 10 cm [4"].

Control panel

To avoid cut-outs near the induction unit, the recommended position for the control panel is either on the front of the kitchen furniture (placed vertically) or inside a drawer (placed horizontally).

If the control panel is to be installed in the countertop, there must be a distance of at least 20 cm [8"] from the frame of the induction system to the cut-out for the control panel.



Installation process

ALWAYS follow the instructions provided by the manufacturer of the induction system.

The Coverlam Top® warranty does not cover any damage caused by improper use of the induction system.